

# Residential Plot For Sale

Benahavís, Costa del Sol

€270,000

Ref: APEX03736444

Unique piece of land in the center of Benahavis. This plot is divided into 5 plots but can easily be divided as one or two plots. 600 m2 can be built on the 1000 m2. The location is just behind the park in Benahavis on the adjacent land a road will be situated, so that this building site is perfectly accessible. Can be joined with the plot next to it, of 3750 m2, that has a building permission for 14 villas.

Telephone: +34 691 71 05 45

Email: [sergio@apexmarbella.com](mailto:sergio@apexmarbella.com)

APEX Marbella Property CC Doña Pepa. Local 6, La Reserva de Marbella - 29604, Marbella - Málaga





# Gallery

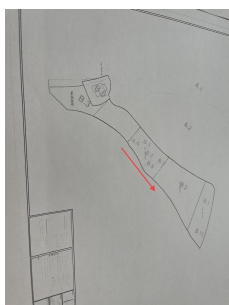
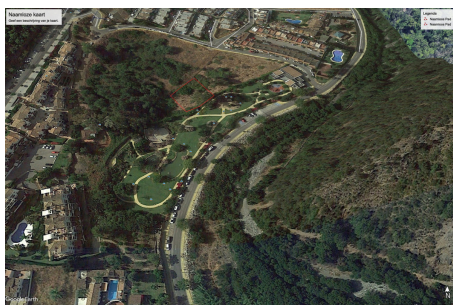
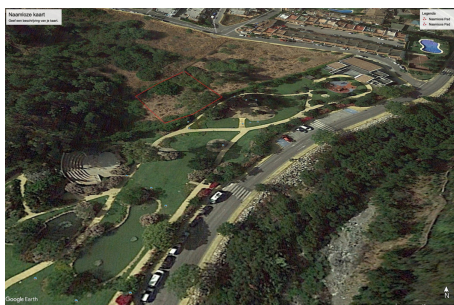

# Property Description

**Location:** Benahavís, Costa del Sol, Spain

Unique piece of land in the center of Benahavis. This plot is divided into 5 plots but can easily be divided as one or two plots. 600 m<sup>2</sup> can be built on the 1000 m<sup>2</sup>. The location is just behind the park in Benahavis on the adjacent land a road will be situated, so that this building site is perfectly accessible.

Can be joined with the plot next to it, of 3750 m<sup>2</sup>, that has a building permission for 14 villas.

**Telephone:** +34 691 71 05 45

**Email:** [sergio@apexmarbella.com](mailto:sergio@apexmarbella.com)

APEX Marbella Property CC Doña Pepa. Local 6, La Reserva de Marbella - 29604, Marbella - Málaga



## Additional Info

For Sale	Type: Residential Plot	Area: 600 sq m
Land Area: 1000 sq m	Setting: Village	Mountain Pueblo
Close To Golf	Close To Town	Close To Schools
Close To Forest	Orientation: East	South East
Category: Investment	With Planning Permission	Internal Area : 600 sq m
Land Size : 1000 sq m		

Telephone: +34 691 71 05 45

Email: [sergio@apexmarbella.com](mailto:sergio@apexmarbella.com)

APEX Marbella Property CC Doña Pepa. Local 6, La Reserva de Marbella - 29604, Marbella - Málaga

